

ACCESSORIES

Description: Quadritalia range of products is completed by a vast range of accessories.

- Ventilation and air conditioning devices
- Locking system
- Suspended panels system
- Spare parts and goodies

ACCESSORIES

TSA - Document pocket - Series OK/AF/AS

Description: the document pockets are available in two versions

- in PVC, colours RAL 2004 and RAL 7035, fixed by means of adhesive film
- in metal, painted RAL 7035 B, fixed to the innere stiffenbing frame of the doors by means of self-threading screws

CODE	Material	Format	Fixing	Width of door	Characteristic dimensions		
					H	L	P
TSA104	PVC RAL 2004	A4	Double face adhesive	-	206	236	30
TSA132	PVC Ral 7035	A4	Double face adhesive	-	206	236	30
TSA106	Metal	A3	Self threading screws	600	292	438	70
TSA107	Metal	A3	Self threading screws	700	292	538	70
TSA108	Metal	A3	Self threading screws	800	292	638	70
TSA111	Metal	A3	Self threading screws	1000	292	838	70
TSA110	Metal	A4	Self threading screws	400	292	223	70

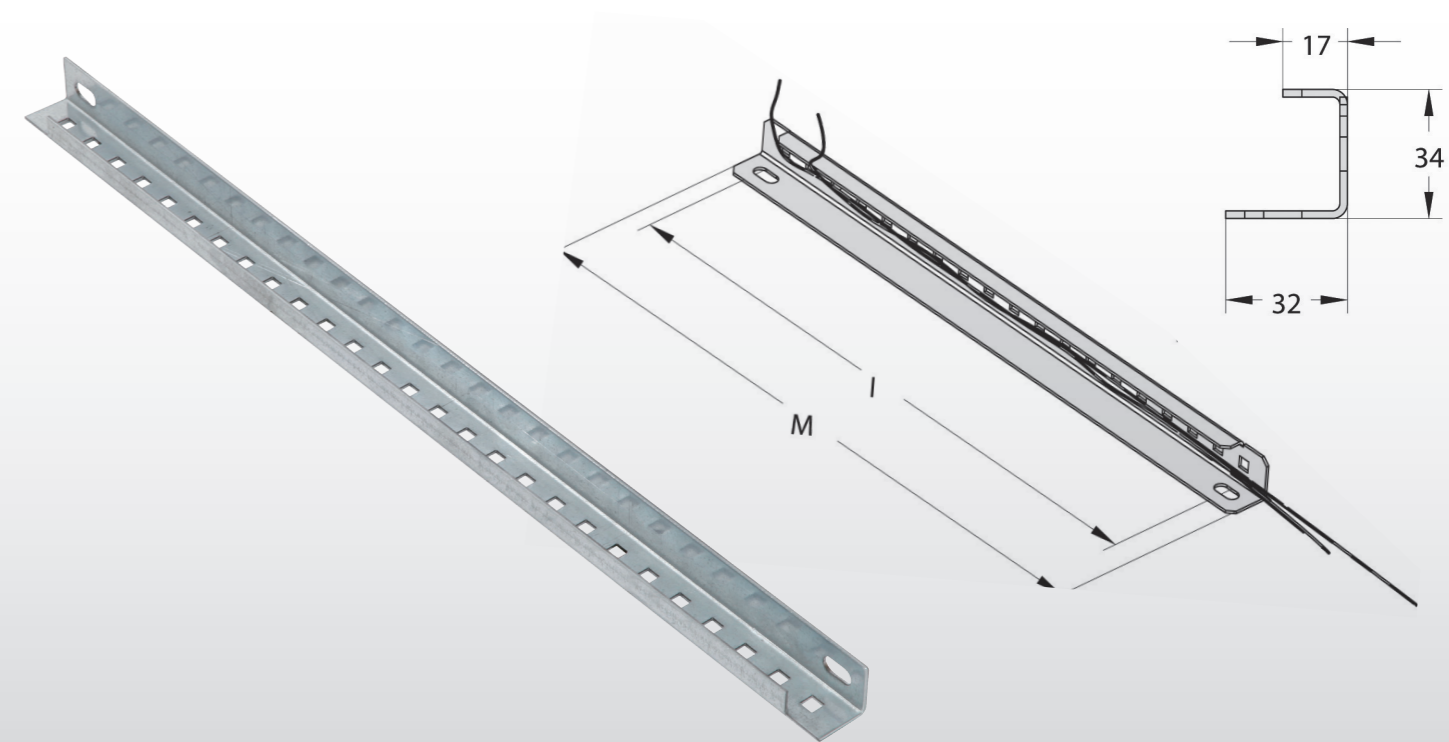
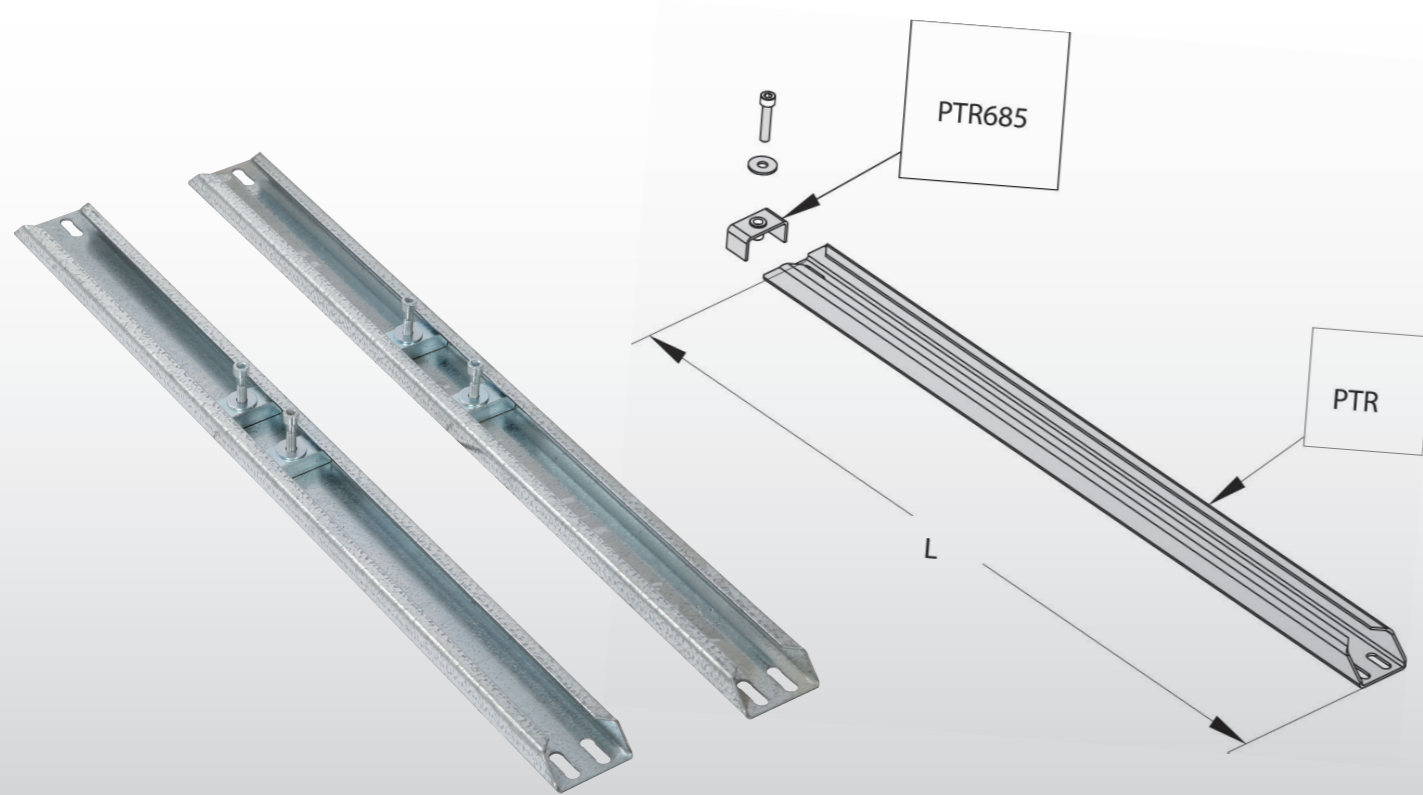

ACCESSORIES

PTR - Transformer support - Series OK/AF/AS

Description: the transformer supports are supplied in pairs, they are usually fixed to the lower horizontal elements of the frame, parallel to the front door or to the side panels.

Code PTR..L includes:

- Pair of transformer supports (piar)

Notes: the PTR685 accessory runs inside the profile

Legenda:

- "X" length of transformer support in mm
- "Y" maximum weight in kg

Esempio:

- On supports **PTR800L** long 800 mm, the "M" maximum weight supported is 180 kg
- On supports **PTR1200L** long 1200 mm, the "M" maximum weight supported is 133 kg

Reading the chart:

The data shown above are valid only for pairs of parallel supports having no intermediate additional fixing points and with non-dynamic items loaded

CODE	Nominal door width	Other Dimensions	
		L	Blocchetto
PTR600L	600	580	PTR685
PTR800L	800	780	PTR685
PTR1000L	1000	980	PTR685
PTR1200L	1200	1180	PTR685
PTR1400L	1400	1380	PTR685
PTR1600L	1600	1580	PTR685
Set of 4 PTR			PTR687

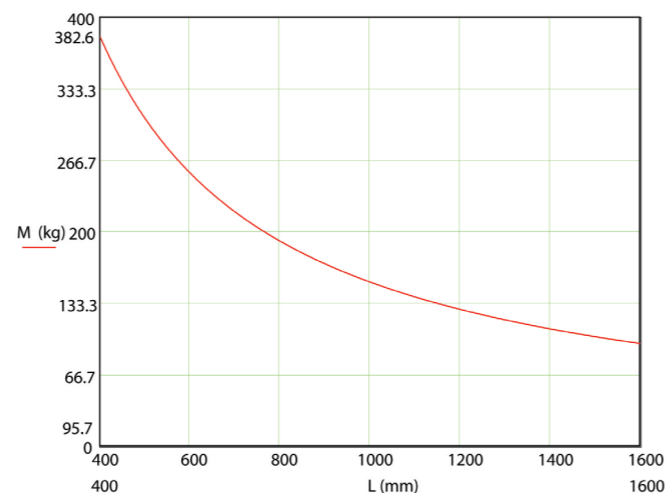

Note: for data concerning PTR in depth direction, please contact our staff.

ACCESSORIES

AMR - Cable holder profile

Description: it is fixed to the lower supporting rails of the mounting plates, it allows the optimal fixing of the cables.

Code AMR includes:

- Cable holder profile
- Fixing screws

CODE	Enclosures width	Other dimensions	
		M	I
AMR040	400	274	252
AMR050	500	374	352
AMR060	600	474	452
AMR080	800	674	652
AMR100	1000	874	852
AMR120	1200	1074	1052
AMR140	1400	1274	1252
AMR160	1600	1474	1452
AMR180	1800	1674	1652



ACCESSORIES

PPVST - Rubber gland plates for enclosures - IP65

Descrizione: metal reinforced cable gland plates, made of various types of polymers, suitable for outdoor and indoor use

CODE	N° Cables	Dimensions	
PPVST02	25	216	84
PPVST03	35	216	84

ACCESSORIES

BCO110 - Mechanic door stay

All series

Description: the door stay prevents accidental closing of the doors, allowing an opening angle of 90° or 120°.

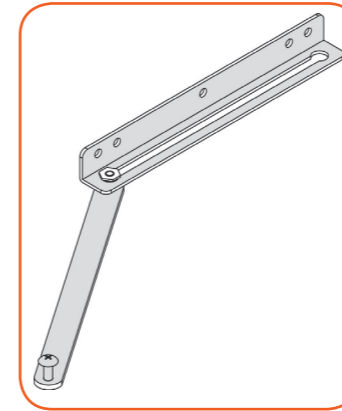

CODE	Features
BCO110	Disassembled kit
BCO110/M	Assembled kit

Notes: if the enclosure has double doors are required two mechanic door stops

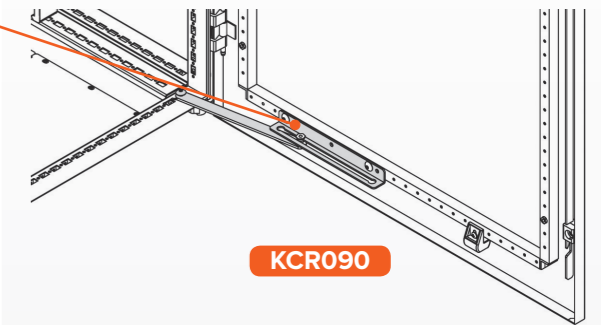

BCK100 - Door block

All series

Description: it blocks two doors contemporarily, one door can then be opened only after the main one has already been opened.

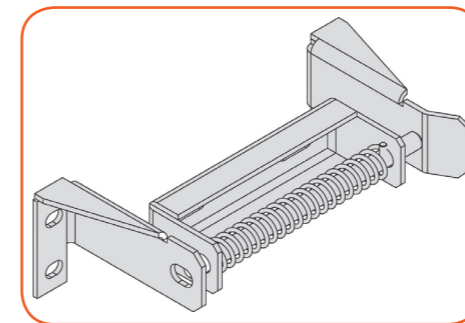

CODE	Features
BCK100	Disassembled kit for enclosures OK
BCK100M	Assembled kit for enclosures OK

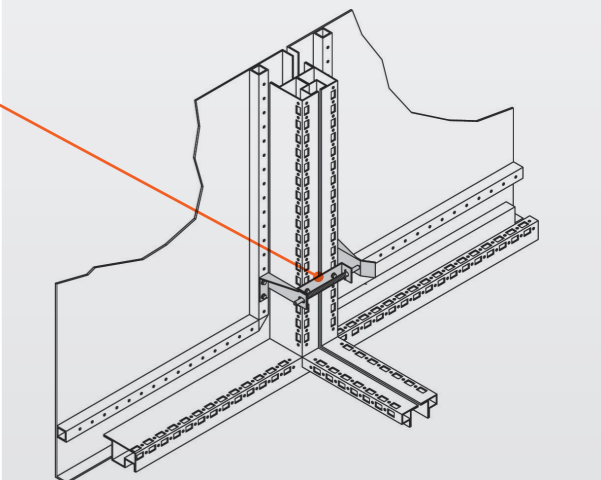

ACCESSORIES

BCO170 - Mechanic door block Series OK

Description: it allows the closing of one door only after the main one has already been closed.

Note: BCO170 is available in left and right version, depending on which is the main door.

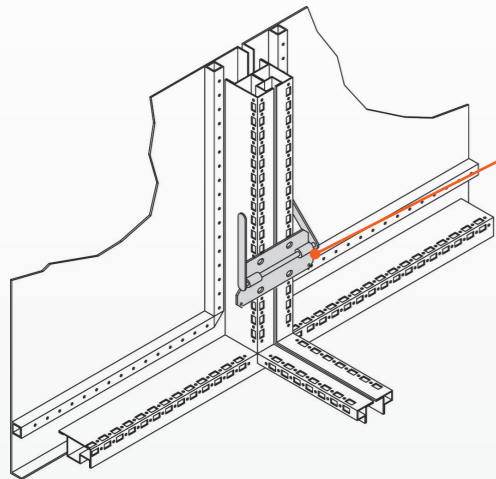
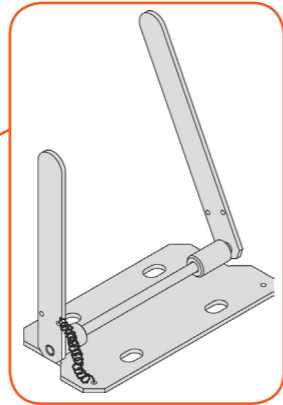

CODE	Type of set
BCO170D	Loose right set
BCO170D/M	Pre-assembled right set
BCO170S	Loose left set
BCO170S/M	Pre-assembled left set

BCC110 - Door block for boxes series ST

Description: prevents accidental closing of the doors, it is universal for both openings (right and left).

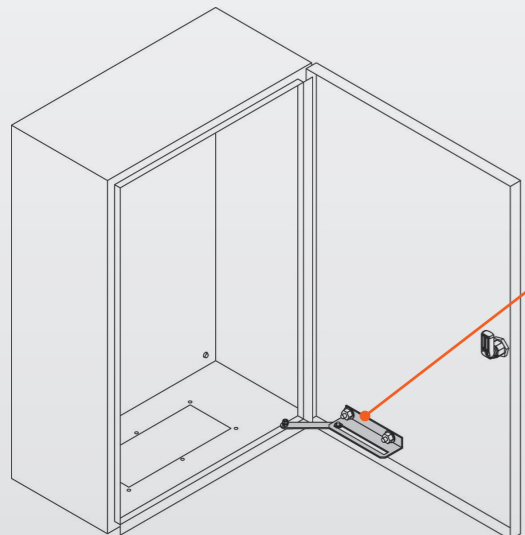
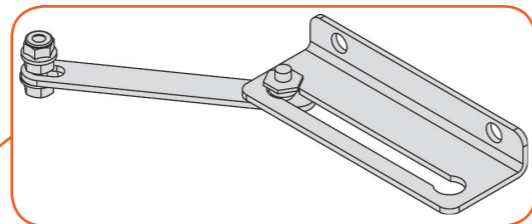

CODE	Type of set
BCC110/S	Disassembled kit
BCC110/M	Assembled kit

ACCESSORIES

KCR090 - Door block for consoles All series console

Description: it is used in pairs as support for the desk cover. The corner element is fixed to the inner part of the cover.

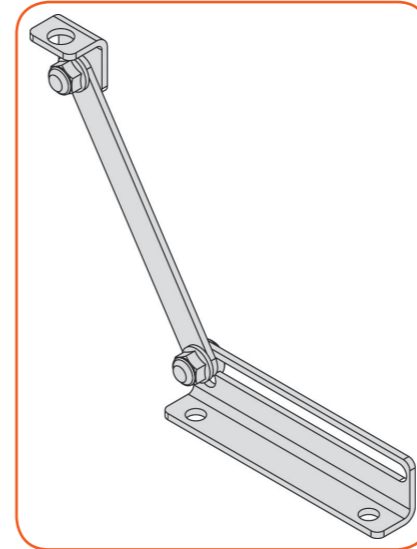

CODE	Type of set
KCR090	Length of oblong slot 90

KMG - Gas spring - All series

Description: prevents accidental closing of covers, panels and doors. Thanks to the compressed gas, they allow easy opening.

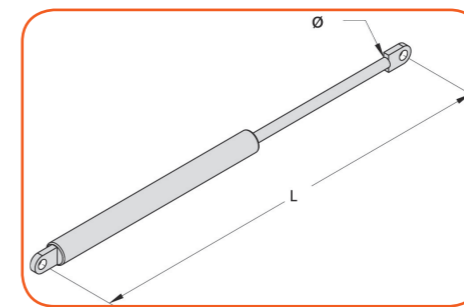

CODE	Action	Flow N°	Dimensions Characteristic	
KMG243/10	thrust	100	243	6
KMG257/20	thrust	200	257	8
KMG444/20	thrust	200	444	8
KMG444/40	thrust	400	444	8
KMG444/50	thrust	500	444	8
KFG182	braking	45	182	6

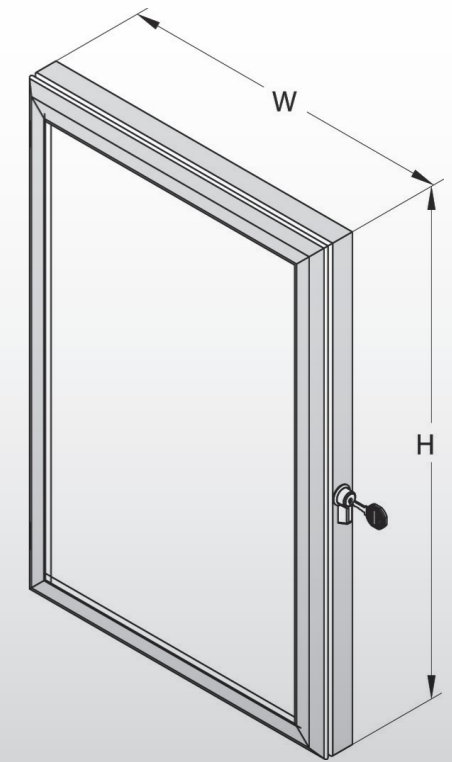
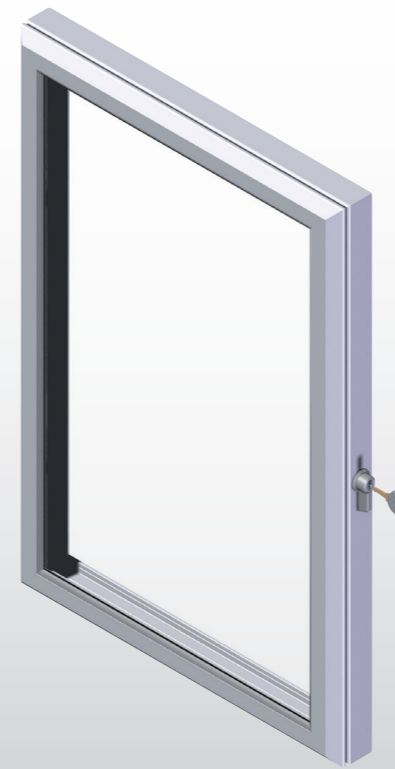
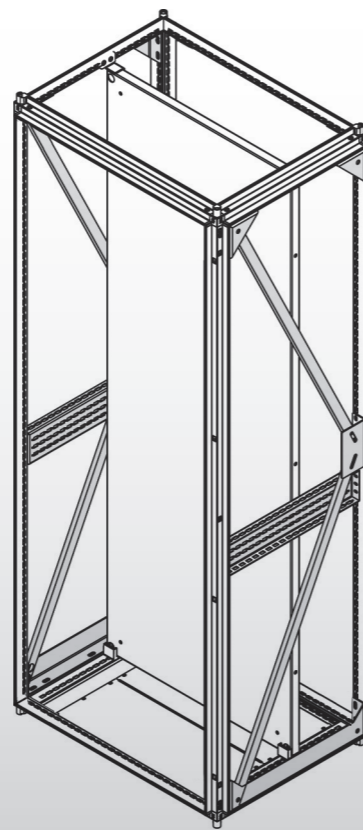

ACCESSORIES

KAS - Earthquake kit - Series OK

Description: for areas at high earthquake risk, an apposite kit is necessary. The kit KAS is made of elements all in thickness 3.0 mm, made up of galvanized steel.

Code KAS includes:

- 2 intermediate brackets (1)
- 2 side profiles h=100 mm code TTK (2)
- 4 corner brackets (3)
- 4 side struts (4)
- 2 base reinforcing elements (5)

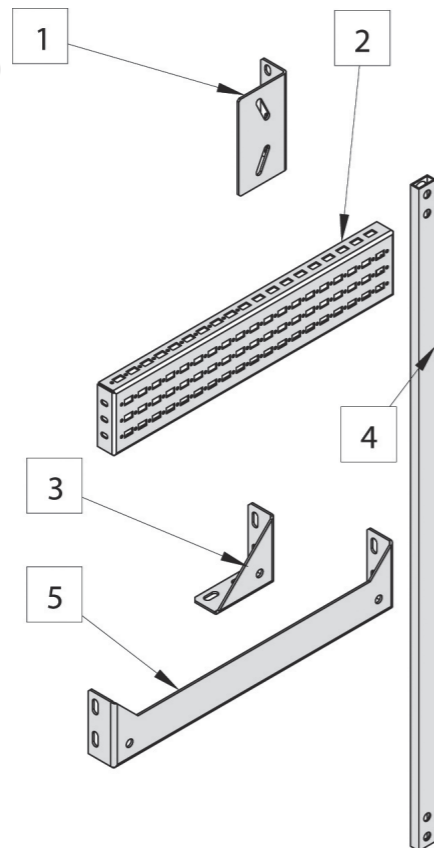

CODE	Enclosures dimensions (HxP)
KAS204	2000x400
KAS206	2000x600
KAS208	2000x800

Note: for information on the specific socket for the anti-seismic kit, contact our staff.

ACCESSORIES

FAV - Aluminium glazed frame all series

Description: LCD screens, keyboards etc. are protected by dust and water by the aluminium glazed frames. Degree of protection is IP 54, thanks to neoprene adhesive film and sealing gasket. The transparent plate is in acrylic glass thick 3.0 mm. Keys are included

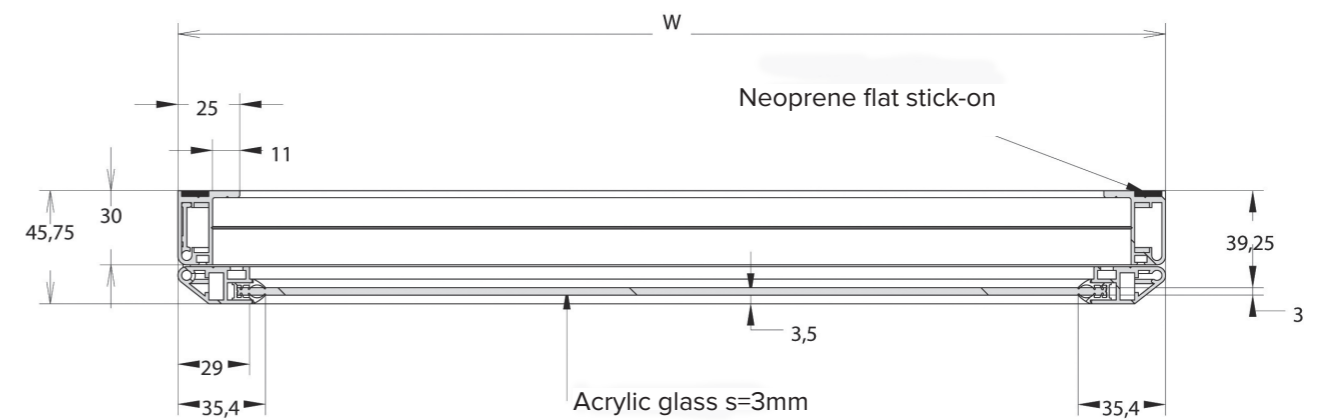

CODE	Characteristics and Dimensions	
	L	P
FAV303	300	300
FAV403	400	300
FAV404	400	400
FAV405	400	500
FAV503	500	300
FAV504	500	400
FAV505	500	500
FAV604	600	400
FAV605	600	500
FAV606	600	600
FAV807	800	700
FAV1005	1000	500
FAV1006	1000	600

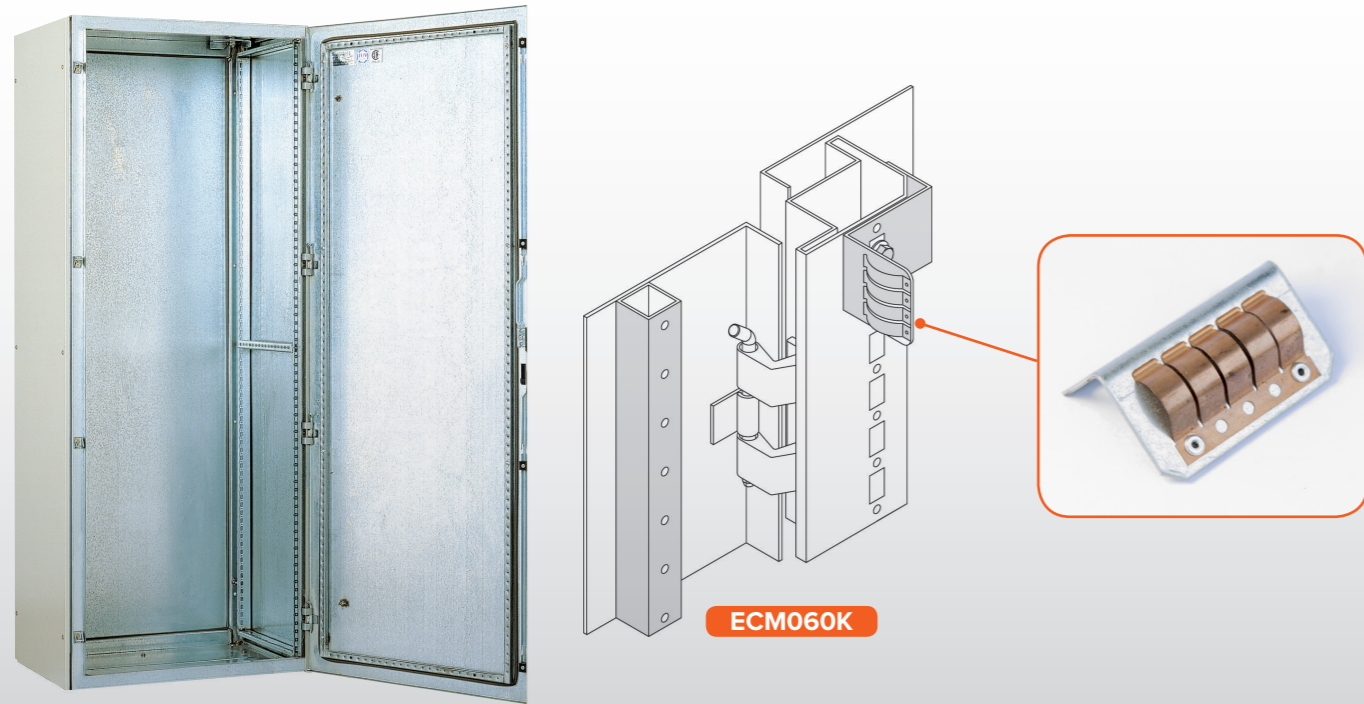

ACCESSORIES

Solutions for electromagnetic compatibility

Description: electromagnetic compatibility is an increasingly important requirement today, since the large number of electronic devices used require high protection against disturbances, and current regulations require shielding.

EMC - Staples for electromagnetic compatibility. The fastest, most effective and cheapest way to reduce electromagnetic disturbances is to apply contact clips, flat earth braids and screened cable entry. These devices, which are designed to create continuity between the structure and removable parts, are sufficient to obtain good attenuation values, maintaining a low cost and the advantage of being applied even after the panel has been installed or installed.

To get a good shielding, 12 ÷ 18 clips on sides and doors are recommended, 8 ÷ 12 on the roof and bottom.

Galvanized structures and panels. To improve the degree of electromagnetic protection it is possible to request panels made entirely of sheet metal galvanized. These panels, painted only externally and equipped with shielded rubber gaskets guarantee both the electromagnetic continuity between the structure and the moving parts, and the degree of protection IP 55.

Filters and fans. All filters are available with EMC protection. The IP 54 degree of protection is still respected.

ECM060K	
CODE	Description
ECM05Z	Staples for enclosures side (20 pieces)
ECM10Z	Staples for enclosures door (20 pieces)
ECM60Z	Bracket with contact spring for cupboard holder (1 piece)

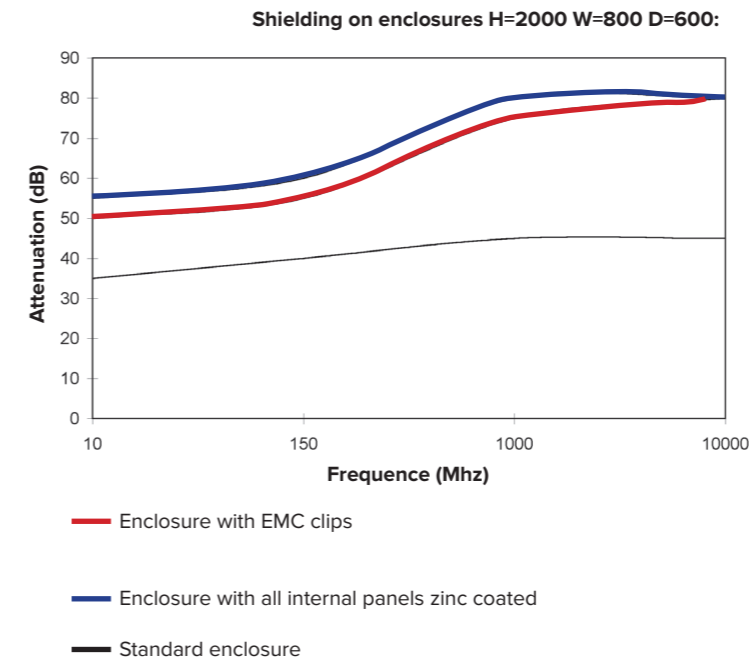

Realization of the tests. The shielding efficiency tests on metal cabinets and boxes have been carried out following the specification 65-6 of the American NSA regarding the Military Standard standards MIL-STD-220. The first graphic reproduced compares three types of panels: standard series, equipped with EMC clips and a fully galvanized cabinet. It should be specified that the graph can vary considerably depending on the size of the frame and the position of the detection. In the specific case the survey was performed on a point located on the back of the panel, at 1400 mm from the ground and centered laterally. The second chart compares two boxes: the first standard and the second completely galvanized. In this case it is not possible to comply completely according to the NSA 65-6 standard since the reduced dimensions of the boxes do not allow to maintain the required distance (30 cm) between the transmitting antenna and the wall of the box under test. Unlike wardrobes, therefore, an anechoic chamber was used. The reported detection was performed on the lower rear edges of the cassette.

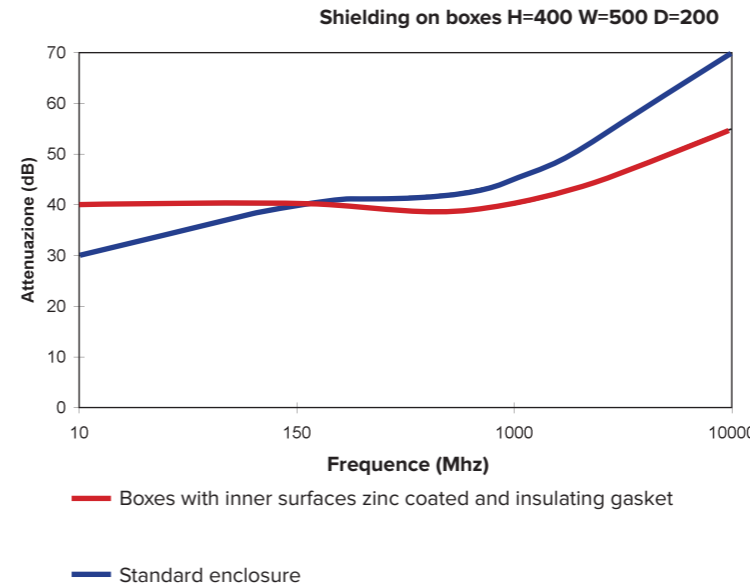

Interpretation of data tests. To compare attenuation values please note the following considerations:

1. it is more difficult to shield a magnetic field than an electric one
2. from 50 Mhz the magnetic and electric fields almost coincide
3. from 50 Mhz the attenuations are inferior for a discourse of impedance (the electric wave and the magnetic one coincide).



SQZ380



SQZ400

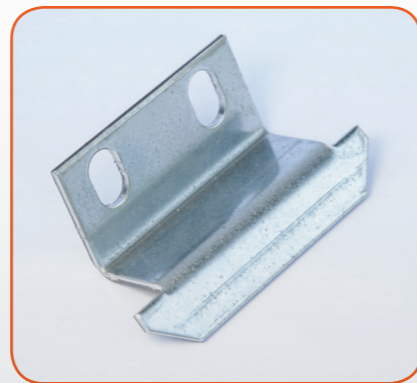

ZCN100



NTL999



SBP100

ACCESSORIES

Auxiliary brackets - Series AS/Console/Series ST

SQZ380

Description: corner bracket for the fixing of the mounting plates to the upper part of the frame of the AS and consoles series.

Note: can be used also for fixing STA and STF profiles.

SQZ400

Description: corner bracket for the fixing of the m.plate to the upper part of the LAS consoles.

On one side the hole is M8, on the other is a slot ø8

ZCN100

Description: corner bracket for series of boxes ST. They are fixed in pairs on the lower edge of the door, and they hook on the lower edge of the box body.

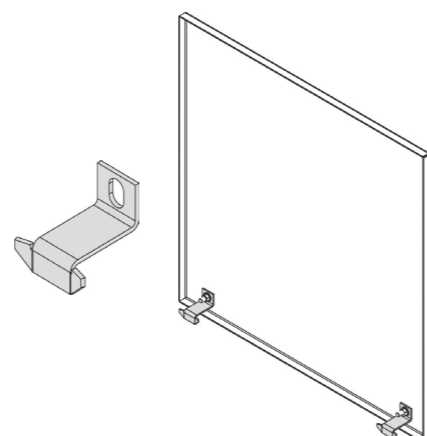

ACCESSORIES

Accessories for doors, Floor Standing Enclosures, Consoles and Wall Mount Boxes

NTL999

Description: the latches are made up of zamak, there are part of the set of accessories for DBE doors.

SBP100

Descrizione: a couple of rubber elements installed at the center of the horizontal elements of the frame useful to ensure the IP protection in case of double doors.



CAP120



CAP120C



CAP180E



CAP180C

ACCESSORIES

HINGES, floor standing enclosures, consoles and wall mount Boxes

CAP120

Description: 120° opening hinge for standard floor standing enclosures, made up of zama, pin in steel (included).

CAP120		CAP120	SCREWS TSP M6	NUT M6	NTK100	SBP100	SCREWS TTIC M6	SCREWS VTR58T
TYPE OF SET	CODE	N°	N°	N°	N°	N°	N°	N°
Kit CAP120 single door H=1200-1400	CAP12001	2	4	4	2	-	-	-
Kit CAP120 single door H=1600	CAP12002	3	7	10	4	-	3	-
Kit CAP120 single door H=1800-2200	CAP12003	4	8	8	4	-	-	-
Kit CAP120 double door H=1600	CAP12022	6	10	14	4	2	4	4
Kit CAP120 double door H=1800-2200	CAP12023	8	12	12	4	2	-	4
Kit CAP120 double door H=1200-1400	CAP12021	4	8	8	2	2	-	4

CAP120C

Descrizione: 120° opening hinge for wall mount boxes.

CAP120C		CAP120C	SCREWS TSP M5	DADO M5 FL.
TYPE OF SET	CODE	N°	N°	N°
Kit CAP120C (single hinge)	CAP120C01	1	1	1

CAP180E

Description: 180° opening for standard floor standing enclosures. It is made up of zama, can be used either on stand-alone enclosures, as on enclosures coupled with others.

CAP180E		CAP180E	SCREWS TSP M6	NUT M6	NTK100	SBP100	SCREWS TTIC M6	SCREWS VTR58T
TYPE OF SET	CODE	N°	N°	N°	N°	N°	N°	N°
Kit CAP180E single door H=1200-1400	CAP180E01	2	8	8	2	-	-	-
Kit CAP180E single door H=1600	CAP180E02	3	10	13	4	-	3	-
Kit CAP180E single door H=1800-2200	CAP180E03	3	12	12	4	-	-	-
Kit CAP180E double door H=1600	CAP180E22	6	16	20	4	2	4	4
Kit CAP180E double door H=1800-2200	CAP180E23	8	20	20	4	2	-	4
Kit CAP180E double door H=1200-1400	CAP180E21	4	12	12	2	2	-	4

CAP180C

Description: 180° opening hinge. Made up of black zama, includes M6 screws.

CAP180C		CAP180C	SCREWS TSP M5	DADO M5 FL.
TYPE OF SET	CODE	N°	N°	N°
Kit CAP180C (single hinge)	CAP180C01	1	-	4

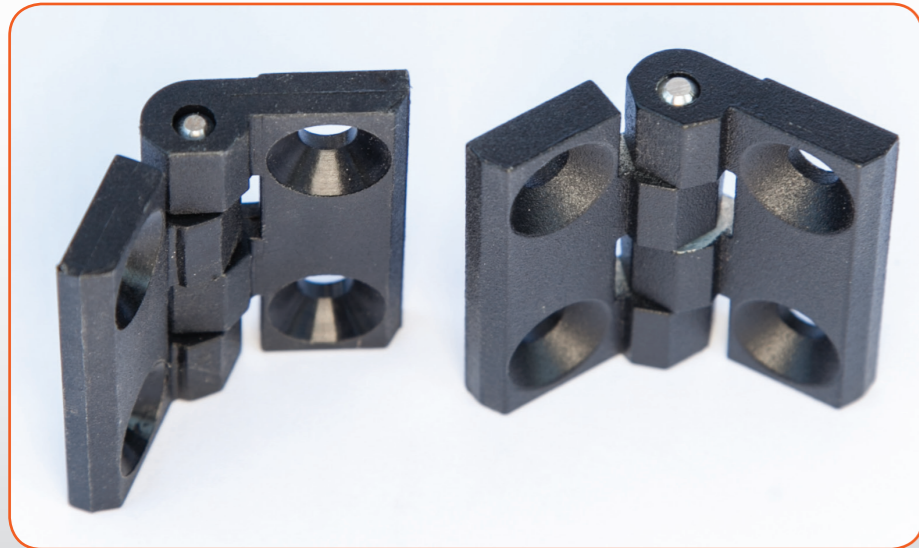

CAP180CA

CAP180CB

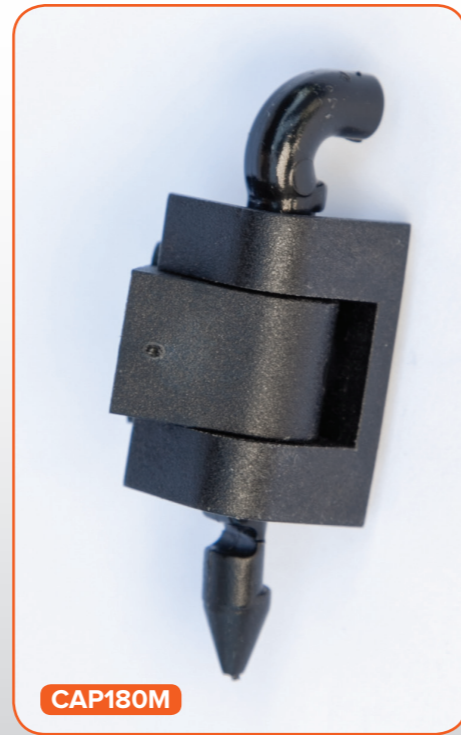

CAP180M

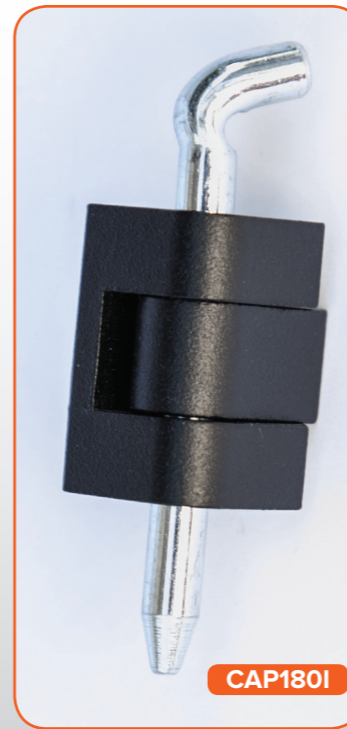

CAP180I

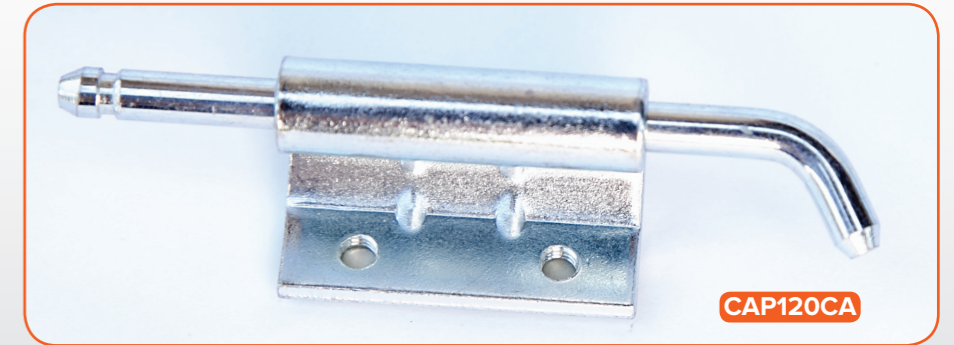

CAP120CA

ACCESSORIES
HINGES, floor standing enclosures, consoles and wall mount Boxes

CAP180CA/CB

Description: 180° opening hinges for wall mount boxes and covers. CAP180CA is in black polyamide, CAP180CB is in black zama.

CAP180CA				
TYPE OF SET	CODE	CAP180CA N°	SCREWS TSP M5 N°	NUT M5 FL. N°
Kit CAP180CA (single hinge)	CAP180CA01	1	4	4

CAP180CB				
TYPE OF SET	CODE	CAP180CB N°	SCREWS TSP M5 N°	NUT M5 FL. N°
Kit CAP180CB (single hinge)	CAP180CB01	1	4	4

CAP180M

Description: Hinges for external modular covers, both pin and hinge are in polyamide.

CAP180M				
TYPE OF SET	CODE	CAP180M N°	SCREWS TSP M6 N°	NUT M6 FL. N°
Kit CAP180M (single hinge)	CAP180M01	1	1	1

CAP180I

Description: Hinge for inner doors for floor standing enclosures. It is made up of black zama.

CAP180I				
TYPE OF SET	CODE	CAP180I N°	SCREWS TSP M6 N°	NUT M6 FL. N°
Kit CAP180I (single hinge)	CAP180I01	1	1	1

CAP120CA

Description: 120° opening for wall mount boxes in steel sheet thick 2.0 mm and for consoles. Both the hinge and pin are in steel.

CAP120CA				
TYPE OF SET	CODE	CAP120CA N°	SCREWS TE M4 N°	WASH M4 Mil. N°
Kit CAP120CA (single hinge)	CAP120CA01	1	2	2

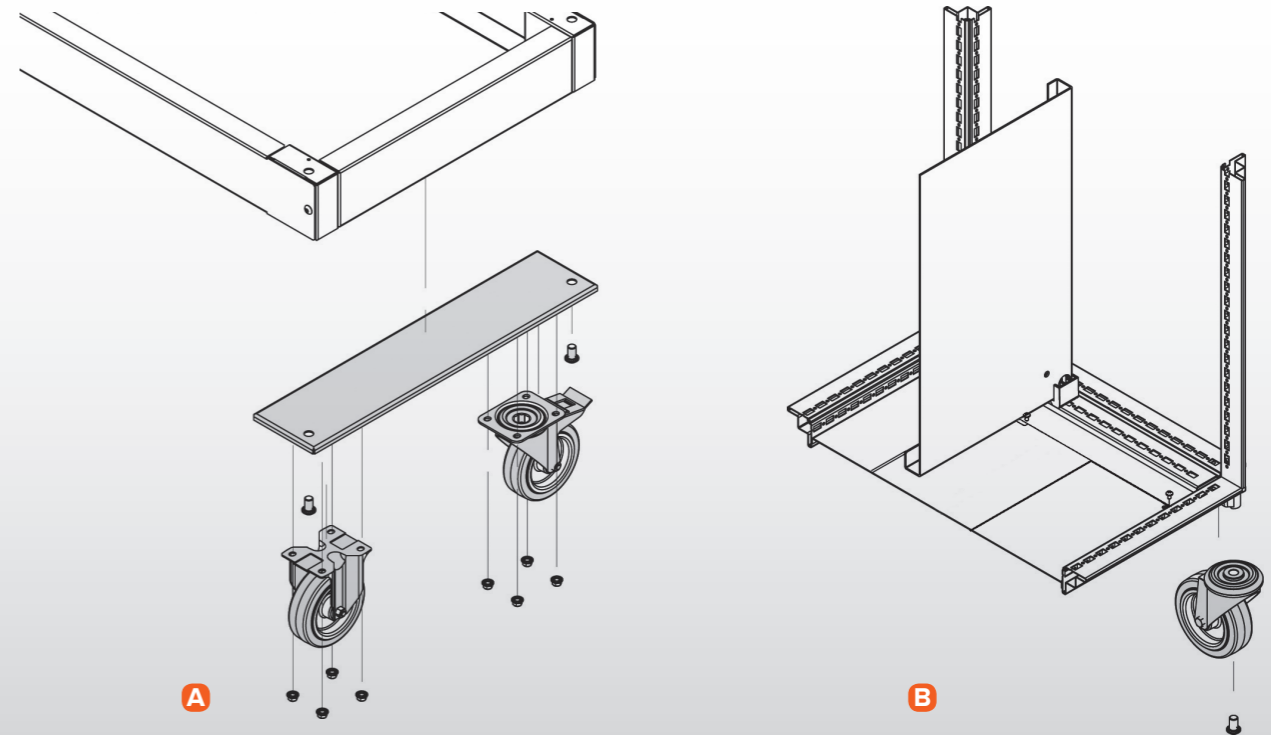
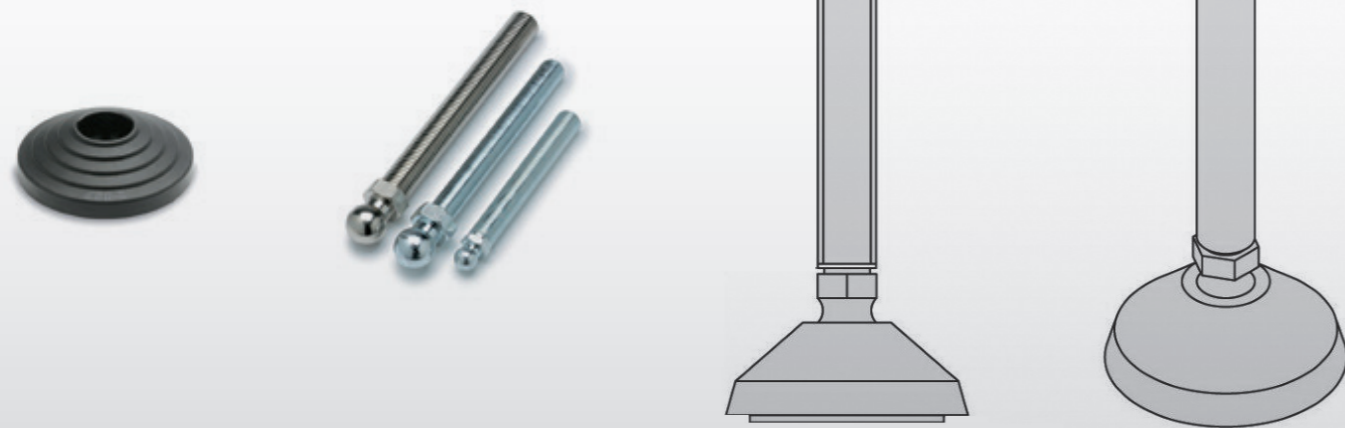

ACCESSORIES

PZC - Adjustable Supports For Floor Standing Enclosures and Consoles

Description: Description: the M12 threaded shank is in galvanised steel, it is adjustable and allows the correct installation of the enclosure on a bumpy ground. The base is in glass-reinforced polyamide. The part in contact with the ground is in thermoplastic rubber, which ensures antivibration effect.

All types of supports, thanks to their threaded shank, can be mounted on the plinth and the bottom part of the enclosure.

CODE	Characteristics
PZC104	Shank H=50 mm (n° 4 pieces kit)
PZC110	Shank H=50 mm inox (n° 4 pieces kit)

SHANKS

CODE	Description	Weight
STFM1243	Shanks in galvanised steel M12 x 43 mm	49
STFM1268	Shanks in galvanised steel M12 x 68 mm	66
STFM1298	Shanks in galvanised steel M12 x 98 mm	87

BASES

CODE	Description	Weight
BA6014	Technopolymer base diam. 60 h=27 mm	32
BA7014	Technopolymer base diam. 70 h=27 mm	30
BA8014	Technopolymer base diam. 80 h=27 mm	53

ACCESSORIES

RGS - Wheel supports

Description: they can be fixed to the plinths or directly to the floor standing enclosures and to the consoles. Besides: example of how to fix some wheel supports to a sealed bottom panel for the OK series. This option reinforces the junction of the enclosure and the wheels supports.

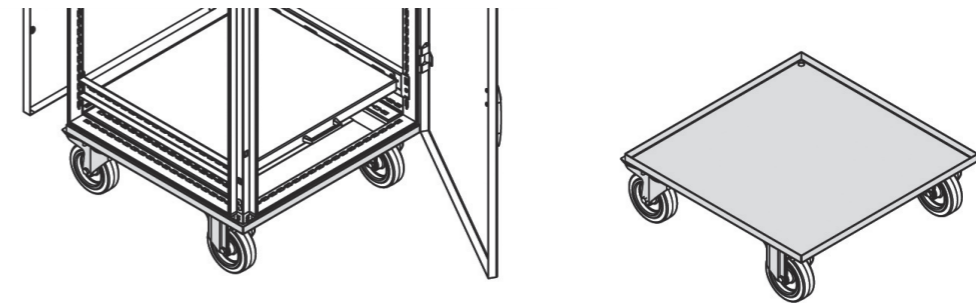

(A) Mounting procedure of the supports on plinths: it is possible thanks to a support for the fixing to a plinth and to welded screws.

Notes: in this case a support is not necessary, the wheel is fixed directly to the joint.

(B) Mounting the wheels directly on the joint of an enclosure series OK

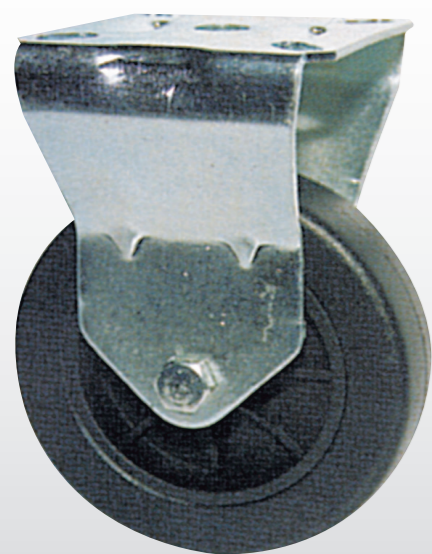

RGO060/Q

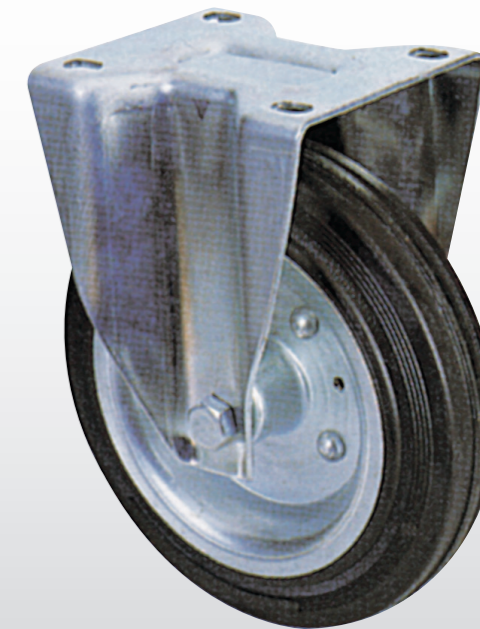
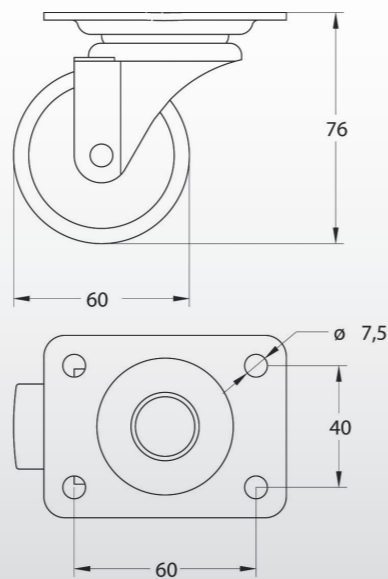
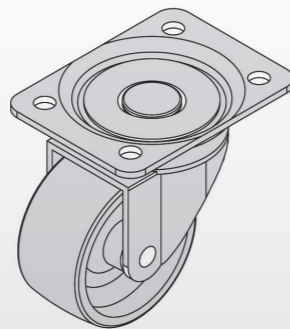

ACCESSORIES

RGF, RGO - Fixed and swinging wheels for floor standing enclosures and consoles

RGF060 - RGO060

Description: diam. ø60, width 24 mm, made of plastic material. Suitable for small enclosures. The wheels rotate on bearings: it includes a welded threaded stud M12 (RGO060), and it also can have a welded plate (RGO060/Q e RGF060/Q). In both versions it can be equipped with a brake (RGF060/F). The galvanised steel support has a load capacity of 50 kg. RGF code indicates that the wheel has the fixed support with identical dimensional characteristics as code RGO060/Q.

ACCESSORIES

RGF, RGO (100-125) Fixed and adjustable wheels

RGF100 - RGO100 - RGF125 - RGO125

Description: Small and medium wheels with solid rubber. Suitable for medium size enclosures each wheel supports max.1225 N [124 kg]. The wheels rotate on ball bearings and the support is in galvanized steel. Brakes available (additional code /F).

RGO060

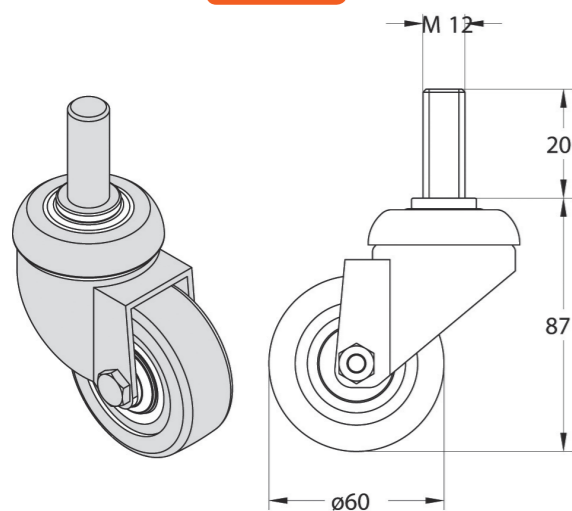

CODE	Type of set		Characteristics		
	Description	Capacity N	Height on ground	Dim. of plates or studs	
RGO060	Adjustable wheel ø60 pin M12	490	87	M12x20	
RGO060/Q	Adjustable wheel ø60 plate support	490	87	80x60	
RGF060/Q	Fixed wheel ø60 plate support	490	87	80x60	
RGO060/F	Adjustable wheel ø60, pin M10 with brake	490	87	M12x20	
RGO060/QF	Adjustable wheel ø60 with plate and brake	490	87	80x60	
RGF060/QF	Fixed wheel ø60, with plate and brake	490	87	80x60	

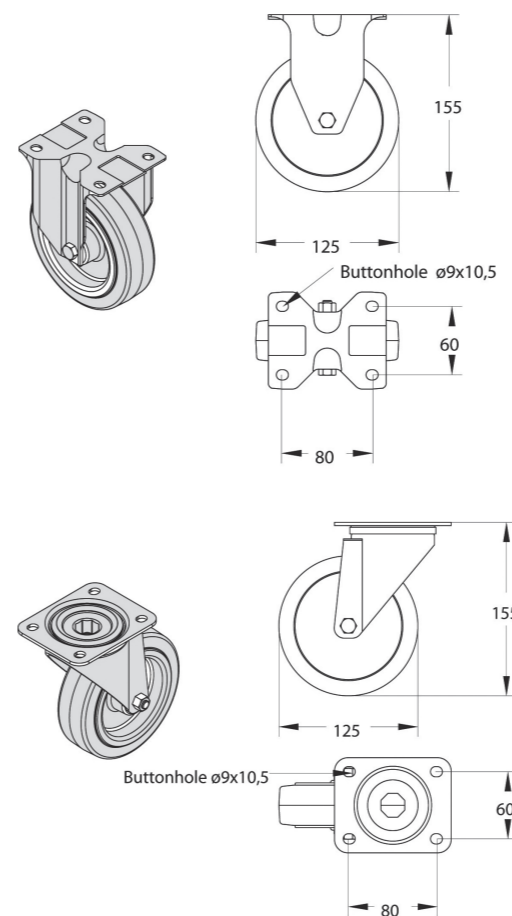

CODE	Type of wheel	Characteristics		
	Description	Capacity N	Height on ground	Dim. of plates or studs
RGO100/Q	Adjustable wheel ø100 with plate	785	128	100x83
RGO100/QF	Adjustable wheel ø100 with plate and brake	785	128	100x83
RGF100/Q	Fixed wheel ø100 with plate	785	128	100x83
RGF100/QF	Fixed wheel ø100 with plate and brake	785	128	100x83
RGO125	Adjustable wheel ø125 with pin M12	1177	155	100x83
RGO125/F	Adjustable wheel ø125, pin M12 and brake	1177	155	M12x20
RGO125/Q	Adjustable wheel ø125 with plate	1177	155	100x83
RGO125/QF	Adjustable wheel ø125 with plate and brake	1177	155	100x83
RGF125/Q	Fixed wheel ø125 with plate	1177	155	100x83
RGF125/QF	Fixed wheel ø125 with plate and brake	1177	155	100x83

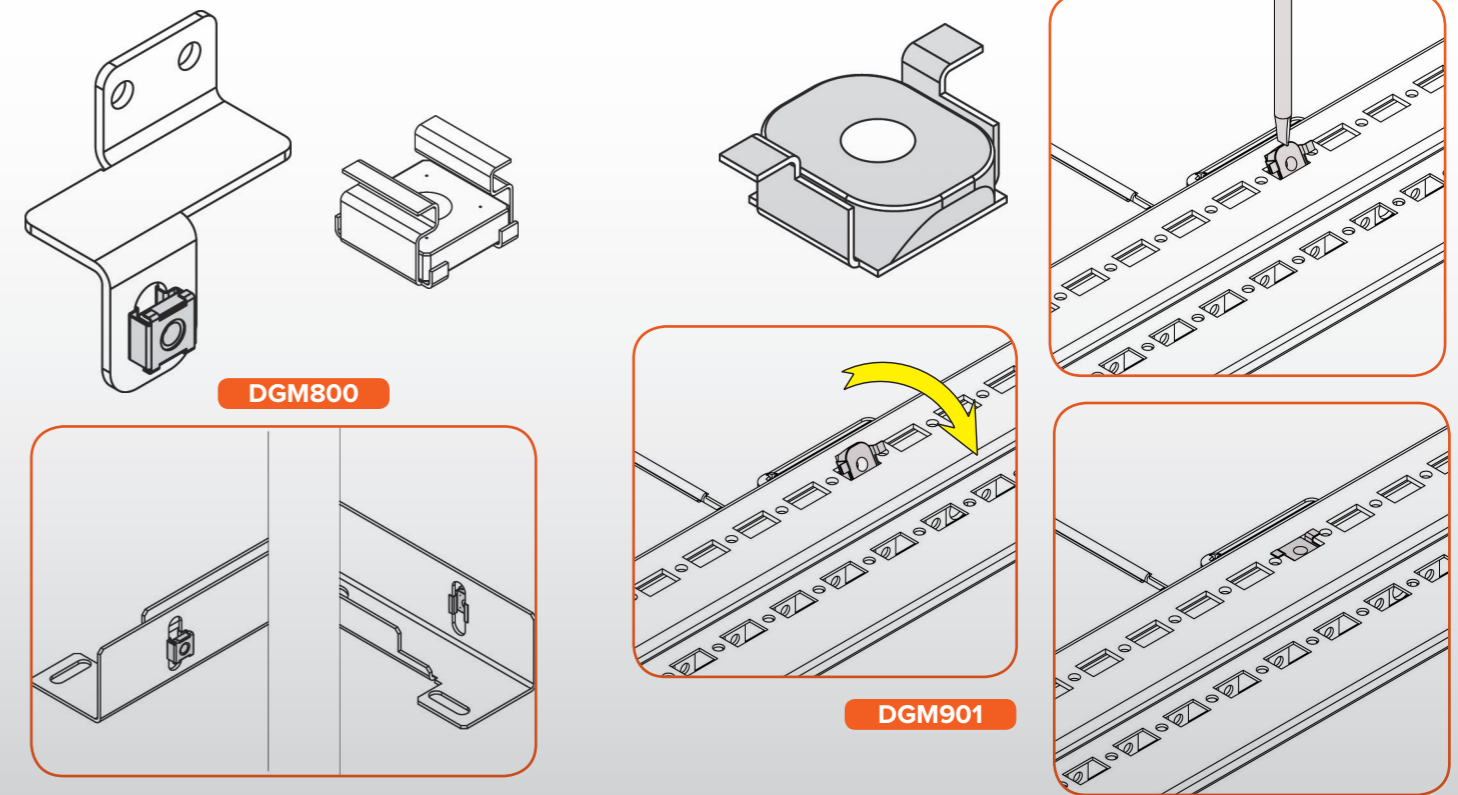
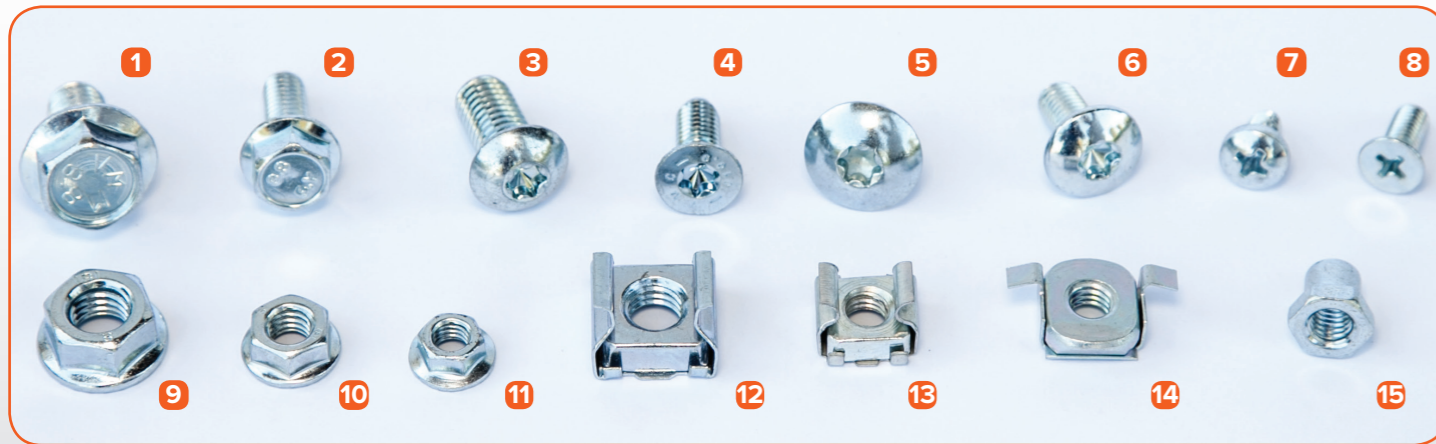

ACCESSORIES

Screws - All series

Description: set of screws and cage nuts in galvanised steel for all types of installations. All items shown are specifically designed for Quadritalia products.

Pos.	CODE	Caratteristiche di fornitura	N° Pezzi
1	VTR800	Flanged screw M8x16 hexagonal head	100
2	VTR616	M6x16 hexagonal head flange screw	100
3	VTC122	TT M8x16 screw torx impression	100
4	VTS616	TSP M6x16 screw Torx T30 impression	100
5	VBC614	TT screw M6x14 torx print T30 cl. 10.9	100
6	VBC616	TT M6x16 screw torx impression T30 cl. 10.9	100
7	VTR510	M5x8 self-sawing trilobed screw	100
8	VTR500	Countersunk head cross bolt M5x12	100
9	DDM800	Flanged M8 nut	100
10	DDM600	Flanged M6 nut	100
11	DDM500	Flanged M5 nut	100
12	DGM800	Cage nut for internal M8	100
13	DGM600	Cage nut for internal M6	100
14	DGM901	Cage nut for external M6	100
15	VTR506	Screw for tubular door frame	100
	VTR600	Flanged screw M6x8 hexagonal head	100
	VTD600	TE M6x8 flanged screw and M6 flanged nut	100
	VTD616	TE M6x16 flanged screw and M6 flanged nut	100
	VTD800	TE M8x16 flanged screw and M8 flanged nut	100

ACCESSORIES

DGM600, DGM800 - Caged nuts M6 and M8

Description: the caged nuts M8 code DGM800 are used in OK series cabinets when their insertion is on the opposite side with respect to the screw. In general, they are used to fix the plates in the upper part: they are inserted in the slit of the bracket (as in fig.) Or, alternatively, they can be used in the presence of 9x9 and 12x12 square slots.

Assembly sequence:

- insertion in the back part of the slit, slightly inclined
- with the tip of a screwdriver, force it into the slotted or square slit
- position it so that the threaded hole is centered with respect to the slot
- fix the component to the nut in a cage using a M6 or M8 screw

DGM901 - Caged nut for outdoor use

Description: the caged nut M6 code DGM901 for outdoor is the most used in OK series cabinets. It allows the fixing of components such as pawls, hinges, crossbars etc. The assembly sequence in a 9x15 rectangular slot is shown below.

Assembly sequence:

- insertion in the slit, slightly inclined
- with the tip of a screwdriver, force it into the 9x15 rectangular slot
- position it so that the threaded hole is centered with respect to the rectangular slot
- fix the component using M6 screw



SRR795

SRR796

SRR786

SRR793

SRR775

SRR776

SRR755

SRR795/YALE
SRR795/CYALE

SRR756



SRR763/PVC

SRR763

SRR762

SRR764

SRR761

ACCESSORIES

Locking systems - Wall mount boxes and consoles

Description: a complete range of locks for wall mount boxes and consoles.
The standard lock for wall mount boxes and consoles is SRR795 in PVC, double bar.

CODE	Features
SRR795	PVC box with 3 mm double bar insert
SRR796	Chromed box with 3 mm double bar insert
SRR766	Chromed box with 7 mm triangle insert
SRR735	PVC box with 7 mm triangle insert
SRR755	Box with "butterfly" handle and Yale type key
SRR756	Box with "T" handle and yale-type key
SRR793	Box with "FIAT" insert and key
SRR775	Box with square escutcheon with 3 mm double bar insert
SRR776	Box with square escutcheon, hooked tongue, 3 mm double bar insert
SRR795/YALE	Box with yale-type lock insert
SRR795/CYALE	Box with chrome yale lock insert

ACCESSORIES

Locking systems - Locks and keys

CODE	Features
SRR763	Black powder-coated zamak key, double 3 mm fins
SRR763/PVC	PVC wrench, double 3 mm fins
SRR762	Zinc black powder wrench, 7 mm triangle
SRR761	Key for handle and chromed box with black polyamide head
SRR764	"FIAT" type wrench, in black polyamide

Locking systems - Floor standing enclosures



ACCESSORIES

Locking systems, handle drives

Description: the standard cabinets are fitted with a SRR799 / M escutcheon and a rail equipped with a double tongue insert. Alternatively, locks can be fitted with a triangular insert, with a FIAT insert, butterfly or key handle and with any other type of closure standardized. As an accessory it is also possible to mount a retractable handle with a vertical drive equipped with a Yale SRR773B type key. The closure can be mounted on the latter type "RONIS 455



CODE	Features
SRR799/M	Ergonomic design locker for cabinets
SRR773A	Concealed handle for double bar insert insert
SRR773B	Retractable handle for Yale-type key rail
SRR700	"T" handle for key type Yale
SRR705	Butterfly handle for Yale-type key rail
SRR184A	Swivel handle in padlockable polyamide
SRR790	Double wing insert for rail (without escutcheon)
SRR780	7mm triangle insert for jib (without flange)
SRR-MSI	Internal release handle for female doors

Note: the SRR799 / M escutcheon can be customized on request with different types of insert: double bar, triangular or yale.

